

**INSTALLATION FOR LED FLOOD LIGHT YOKE / KNUCKLE BRACKET  
FLS44 / FLM44 SERIES**

**SAVE THESE INSTRUCTIONS - READ ALL INSTRUCTIONS CAREFULLY**
**⚠ WARNING**

**PLEASE READ ALL INSTRUCTIONS BEFORE ATTEMPTING INSTALLATION.**

- Before starting installation, please inspect fixture for any visible damage. If damaged, do not install fixture.
- The fixture and components should not be mechanically stressed.
- Installation must not damage any conductor or other components.
- Installation and maintenance should only be done by qualified personnel and in accordance with local, regional and national electrical codes.
- Please ensure power is turned off at breaker prior to installation or maintenance.
- Correct electrical polarity must be observed.
- If mounting on metallic or other conductive surface, there should be an electrical insulator between the fixture and mounting surface.
- Do not operate LEDs in reverse bias.
- Damage caused by corrosion will not be accepted as a material defect. It is the installers responsibility to ensure proper protection and components are employed against moisture and condensation and other harmful elements.
- Identify Positive (+) and negative (-) outputs of the power supply using multimeter.
- Electrical connection must be in a dry area unless adequately sealed.
- This fixture emits high light output - do not look directly into the light emitting area. Direct exposure to light over an extended period may harm vision.
- If the external flex cable or power cord of this fixture is damaged, it must be replaced by the manufacturer or his service agent to avoid electrical hazard.

**PARAMETERS**

PART NUMBER	INPUT VOLTAGE	FREQUENCY	POWER	RATED CURRENT
FLS44-1014N-BL-YK / FLS44-1014N-BL-KN	AC120V	60Hz	10W	0.1A
FLS44-30U4N-BL-YK / FLS44-30U4N-BL-KN	AC120 - 277V	50 / 60Hz	30W	0.34A
FLM44-50U4N-BL-YK / FLM44-50U4N-BL-KN	AC120 - 277V	50 / 60Hz	50W	0.56A

**SURFACE MOUNTING INSTALLATION**

1. Do not remove any part of the fixture.
2. Please read specification label on fixture.
3. Use expansion hardware to secure the fixture to mounting surface.
4. Ensure there is enough lead length to accommodate adjusting fixture angle.
5. Connect wires into junction box: White wire to "Neutral" terminal, Black wire to "Live" terminal, yellow/green wire to "Ground" terminal: Use proper wire nuts.

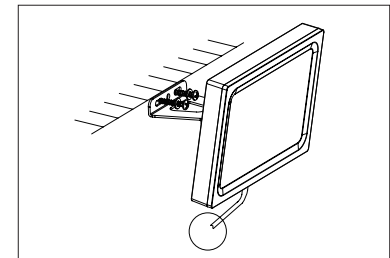
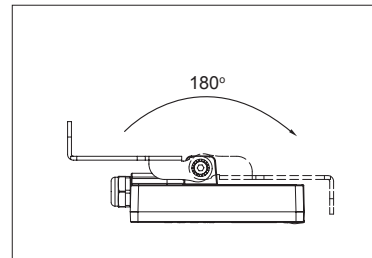
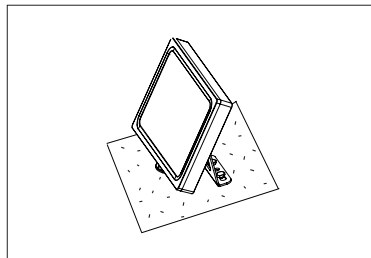
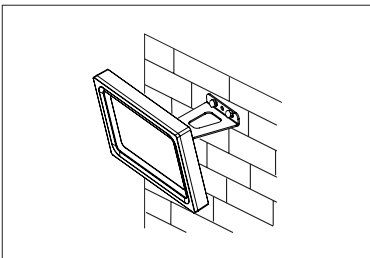
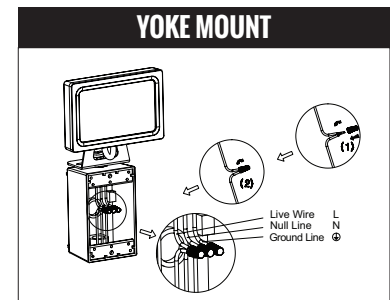
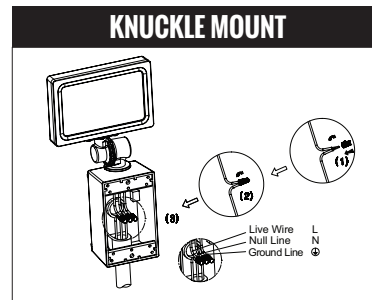

## INSTALLATION FOR LED FLOOD LIGHT YOKE / KNUCKLE BRACKET FLS44 / FLM44 SERIES

SAVE THESE INSTRUCTIONS - READ ALL INSTRUCTIONS CAREFULLY



### INSTALLATION INSTRUCTION - YOKE MOUNT

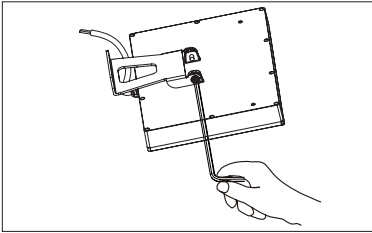

1. Turn mounting bracket right position as picture shows. Lock mounting bracket with socket head wrench.

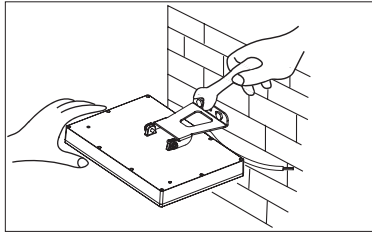

2. Align mounting holes on lamp bracket with hole on mounting surface. Lock with wrench, screw locking torque should be no less than 8N.m.

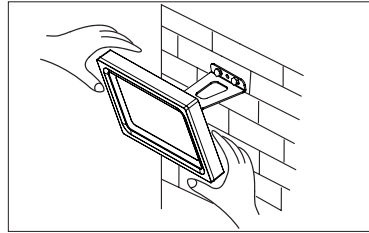

3. Lamp can be adjustable to suitable position by angle indicate line. Use hexagon wrench locking again.

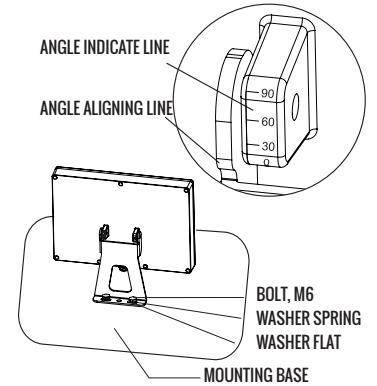

### INSTALLATION INSTRUCTION - KNUCKLE MOUNT WITH ROUND JUNCTION BOX

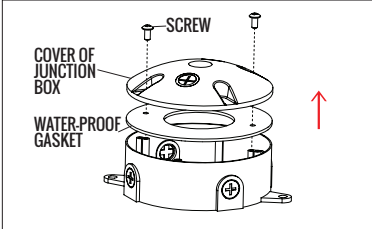

1. Use screw key to open the junction-box.

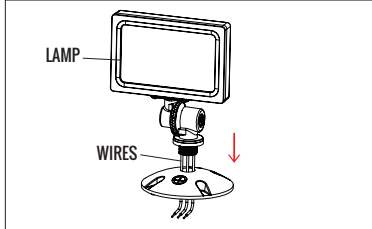

2. Put the wires of lamp into the junction-box.

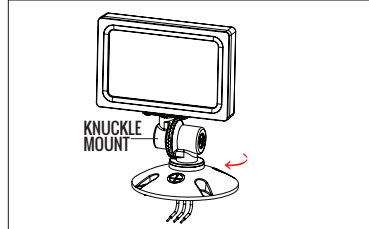

3. Screw up the knuckle mount into junction-box.

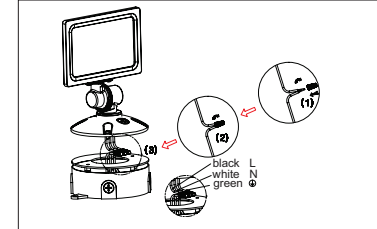

4. Use wire-nuts to connect the wires of lamp and junction-box.

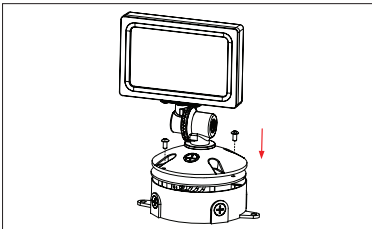

5. Lock the junction-box with screw key.

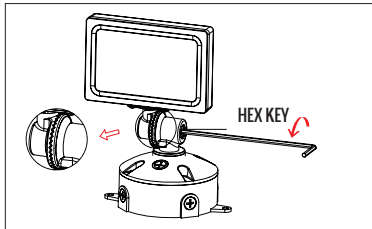

6. Use hex-key to screw off the hex screw in knuckle mount.

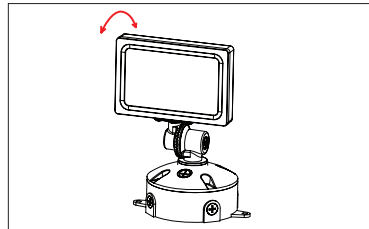

7. Adjust the lamp into suitable angle.

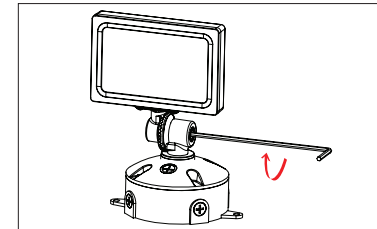

8. Use hex-key to screw up the hex-crew. Installation complete.

### WITH SQUARE JUNCTION BOX

